

# DELLA®

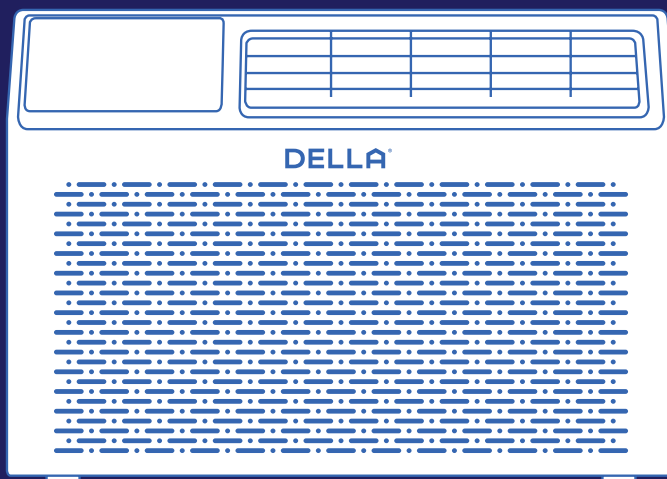

## Fenestra Window AC (8K - 14K)

Instruction Manual  
Installation and Operation Guide





# Table of Content

<b>Before Installation</b>		<b>Care and Maintenance</b>	
Warning and Safety	04	Air Filter	27
Name of Parts	07	Maintenance Routine	28
Product Specification	08	<b>Having Problems?</b>	
<b>Installation</b>		Troubleshooting	29
Installation Preview	09	Disposal Guideline	31
Installation	10	Warranty	32
<b>Before Using</b>			
Operation Tips	17		
Parts of the Air Conditioner	18		
Control Panel	19		
Remote Control	20		
<b>Basic Operation</b>			
Power ON / OFF	22		
Operation Modes	22		
- Cool, Fan, Dry, Auto	22		
Change Temperature	23		
Change Fan Speed	23		
<b>Advance Function</b>			
Timer	24		
ECO Mode	24		
Sleep Mode	25		
Display ON / OFF	25		
Filter Reset Button	25		
Wi-Fi Reset Button	25		
Wi-Fi Setup	26		

## Warning and Safety

- Read this guide before installation. Failure to follow the safety instructions may result in property damage, serious injury, or death.
- Please Keep this manual.



**Danger:**

Indicates an **IMMINENTLY** hazardous situation that, if not avoided, will result in death, serious injury, or serious property damage.



**Warning:**

Indicates an **POTENTIALLY** hazardous situation that, if not avoided, will result in death, serious injury, or serious property damage.



**Caution:**

Indicates an **POTENTIALLY** hazardous situation that, if not avoided, will result in minor to moderate injury. It may also be used to indicate unsafe practice.



**Attention:**

Pay additional attention to the instruction.



**DO NOT:**

Indicates prohibited actions and / or practice.

### About Refrigerant



- The air conditioner is pre-charged with refrigerant. Handle the air conditioner with care and check if there is any refrigerant leakage during installation. Refrigerants have no odor and can be toxic and flammable. Rapid evaporation of refrigerant may cause frostbite, cardiac arrhythmia, and / or irritation, as well as cause environmental damage.



- In the case of refrigerant leakage, shut down the appliance and disconnect from the power supply. An inspection must be performed by a qualified technician.

### About Installation



- Do not install or use this appliance in the bathroom, laundry area, or places that might come into contact with water.
- Do not install or use this appliance near flammable substances such as alcohol, gasoline, paint, etc. Or pressurized containers such as spray cans.







- Do not store, install or use this appliance in a room with continuously operating ignition sources such as open flames, gas appliances, or electric heater.
- Do not alter, change, or modify the appliance.





- The window AC must be stored at its upright position for at least 48 hours before installation to allow the compressor's oil to settle and prevent damaging the compressor.
- Prevent children from accessing the work area during installation to prevent unforeseeable accident.
- The appliance must be securely attached to the window or wall opening to prevent the AC from falling out.
- Carry out a test run after the installation.
- The appliance should not be installed in a location where the air outlet of the unit is obstructed. Obstruction of these opening may cause damage or malfunctions to the appliance.
- Wear protective gloves and clothing during installation to prevent cuts or injuries.



Warning and Safety

About Power and Electricity	
<div> WARNING</div> <div></div>	<ul style="list-style-type: none"><li>▪ Ensure that the power voltage corresponds to that stamped on the rating plate.</li><li>▪ Make sure this appliance is connected to a properly grounded power outlet to prevent electric shock.</li></ul>
<div> WARNING</div> <div></div>	<ul style="list-style-type: none"><li>▪ Do not bend, tug, or compress the power cord during installation to prevent damaging the power cord. Damaged electrical cord should be replaced by a qualified electrician.</li><li>▪ This appliance must be plugged directly into a wall power socket. Do not use power extensions and / or multi-socket modules for appliance installation.</li></ul>

About Operation	
<div> WARNING</div> <div></div>	<ul style="list-style-type: none"><li>▪ Do not disconnect the appliance from the power supply before shutting off the appliance. This might create a spark and potentially cause a fire.</li><li>▪ Do not place flammable substances near the appliance.</li><li>▪ Do not climb onto or place any objects on the appliance.</li><li>▪ Do not insert any objects into the appliance to prevent damage or injury.</li><li>▪ Do not obstruct the air inlet or outlet.</li><li>▪ Do not operate the appliance with wet hands.</li></ul>
<div> CAUTION</div>	<ul style="list-style-type: none"><li>▪ If the appliance is used in areas without the possibility of ventilation, precautions must be taken to prevent any leaks of refrigerant.</li><li>▪ Only use the appliance as instructed in this booklet. These instructions are not intended to cover every possible condition and situation. As with any electrical household appliance, common sense and caution are therefore always recommended for usage and maintenance.</li><li>▪ This appliance is designed and made for air conditioning in domestic environments only. It must not be used for any other purpose such as drying clothes or cooling foods.</li><li>▪ This appliance can be used by children 8 years old or above and persons with reduced physical, sensory, or mental capabilities, or lack of experience and knowledge if they have been given supervision or instruction concerning the use of the appliance in a safe way and understand the hazards involved.</li><li>▪ Children shall not play with the appliance.</li></ul>

## Warning and Safety

Before Installation  
Before Installation

### Encountering Troubles



- In the case of the appliance emitting smoke, burning smell, leaking water, or making unusual noise, shut down the appliance and disconnect from the power supply immediately. Contact a qualified technician for inspection and repair.

### About Handling and Maintenance



- Do not attempt to disassemble, alter, or modify the appliance.
- Do not flush the air conditioner with water.



- Repairs should be carried out by a professional or qualified technician only. Incorrect repair could expose the user to potential electric shock or other kinds of hazard.
- Before cleaning the unit, the appliance must be shut down and disconnect from the power supply for at least 5 minutes.

# Name of Parts Package Contents

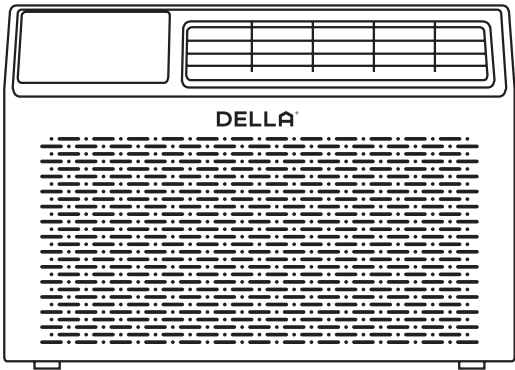

Window AC  
1x

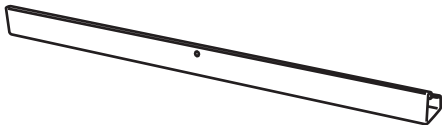

Top Rail  
1x

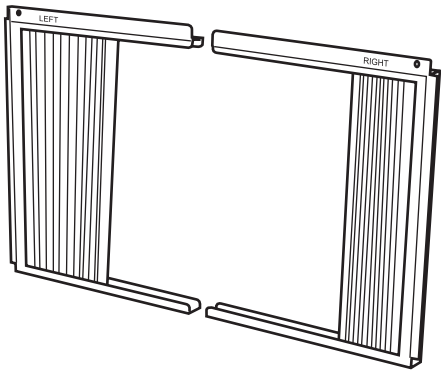

Filler Panel Set  
1x

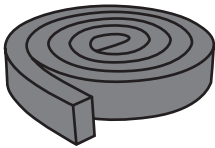

Window Sach Seal  
1x



Remote Control  
1x



Sach Lock  
1x

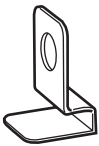

Lock Frame  
2x

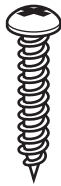

3/4" Screws  
4x

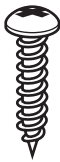

1/2" Screws  
3x



3/8" Screws  
4x

## Tools Needed (Not included)

- Screw Driver
- Power Drill
- Refrigerant Leak Detector
- Measuring Tape
- Thermometer
- Cutter / Scissors

Product Specification

Before Installation  
Before Installation

048-TL-W8KWD		048-TL-W10KWD	048-TL-W12KWD	048-TL-W14KWD
Power Supply		115 V / 60 Hz / 1P	115 V / 60 Hz / 1P	115 V / 60 Hz / 1P
Rated Capacity (Btu/h)		8000	12000	14000
Power Consumption		730 W	1090 W	1290 W
Rated Current		8 A	11 A	12.0 A
Noise Level	Indoor	54 - 58 dBA	56 - 60 dBA	54 - 60 dBA
	Outdoor	58 - 62 dBA	61 - 65 dBA	60 - 64 dBA
Dimension		18.58" x 17.05" x 13.31" 472 mm x 433 mm x 338 mm	19.76" x 22.91" x 15.16" 502 mm x 582 mm x 385 mm	19.76" x 22.91" x 15.16" 502 mm x 582 mm x 385 mm
Net Weight		44.8 lb / 20.3 kg	63.7 lb / 28.9 kg	69.4 lb / 31.5 kg
Suitable Area		250 - 350 sq. ft	450 - 550 sq. ft	550 - 700 sq. ft
Moisture Removal (per hour)		2.3 pints / 1.1 L	3.6 pints / 1.7 L	4.4 pints / 2.07 L
Refrigerant Type		R32	R32	R32
Refrigerant Amount		8.99 oz	11.29 oz	14.1 oz

# Installation Preview

## Window Requirement

The air conditioner is deisnged to be installed in a standard single-hung or double-hung window. The AC would not fit in other window types.

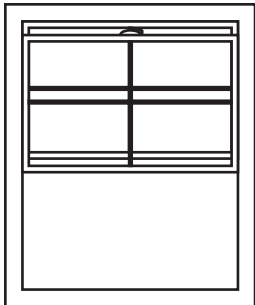

Single Hung / Double Hung Window

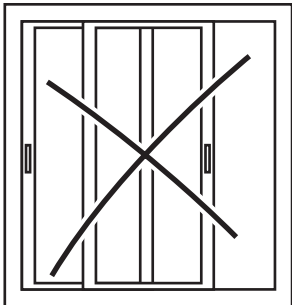

Sliding Window

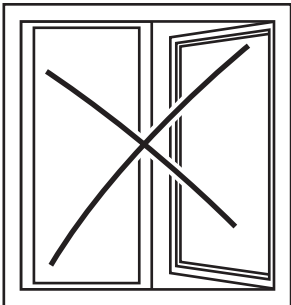

Casement Window

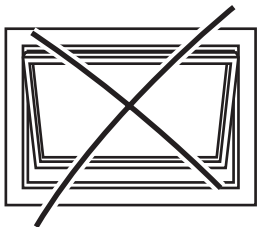

Awning Window

Make sure your window has enough clearance for the window AC to be properly seated in the opening.

### Window Opening Size Requirement for Installation

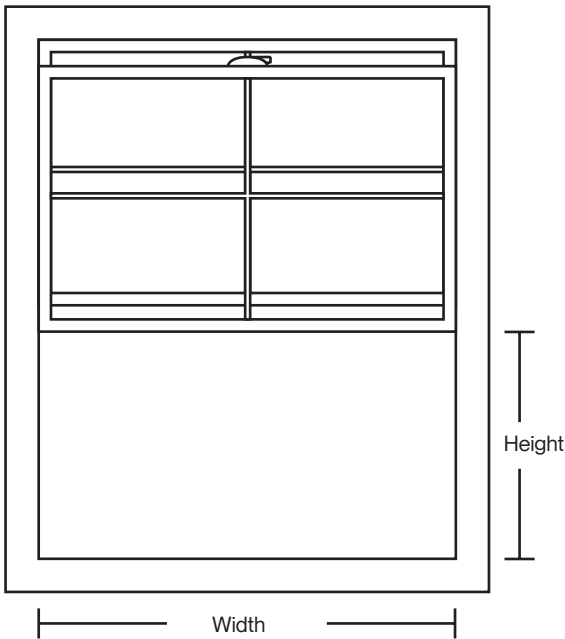

	048-TL-W8KWD	048-TL-W10KWD	048-TL-W12KWD	048-TL-W14KWD
Width	23" - 36"	23" - 36"	26" - 36"	26" - 36"
Height	≥ 14.5"	≥ 14.5"	≥ 16"	≥ 16"

## Installation Preview

### Picking a Installation Location

- Do not install the unit near a heat source, steam, or flammable gas.
- Do not install unit in a location where drain water would cause inconvenience to others.
- Make sure the window AC is installed in places where the power cord is long enough to reach an power outlet.
- Make sure there is no objects near the installation site which would obstruct air flow.

## Installation

### Attach Top Rail



- Wear protective gears when installing the AC to prevent cuts or injuries from sharp metal edges.
- Installation should performed by 2 people to prevent accident.



1. Attach the top rail on top of the window AC and secure it using 4x 3/8" screws.

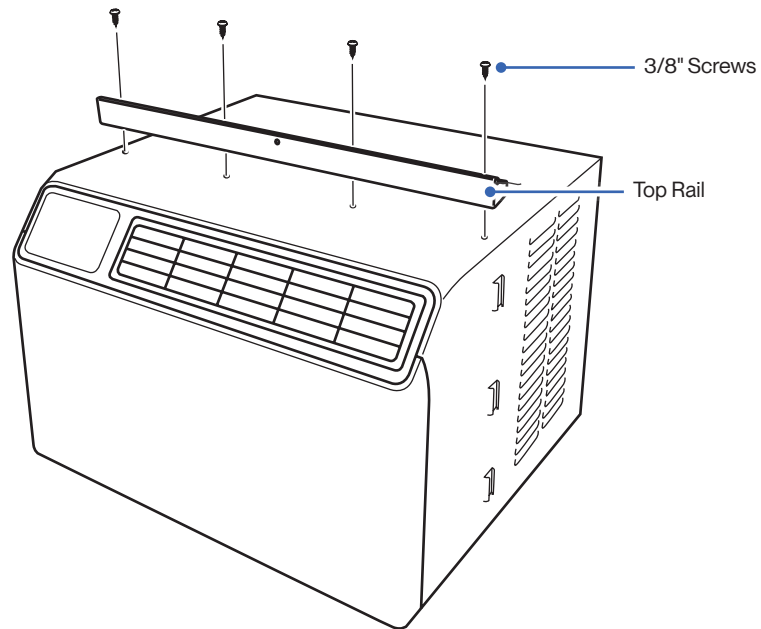

# Installation

## Attach Filler Panels

1. Fully extend the filler panels.

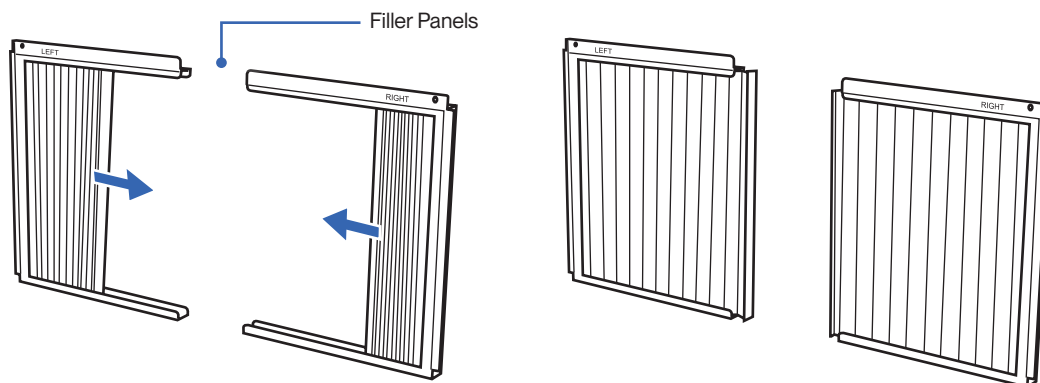

2. Slide the filler panels to the sides of the window AC.

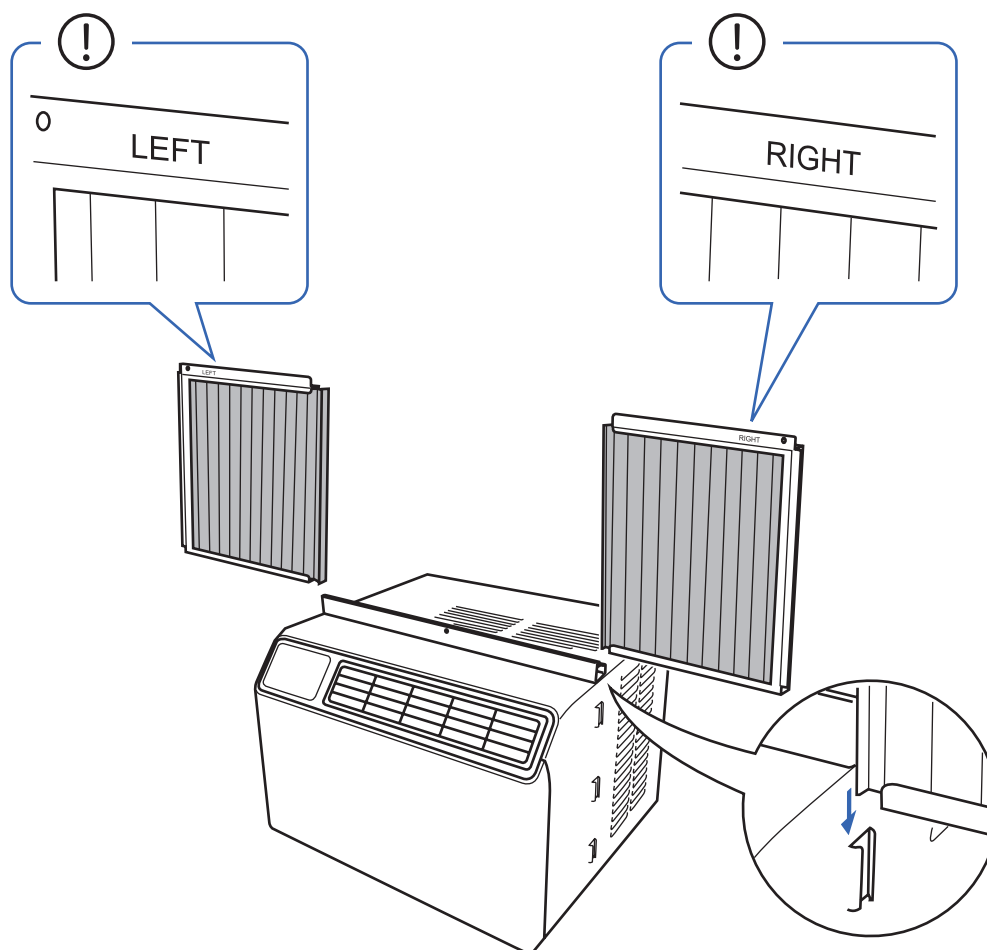

## Installation

### Attach Filler Panels

3. Insert the filler panels to the top and bottom rails of the window AC.

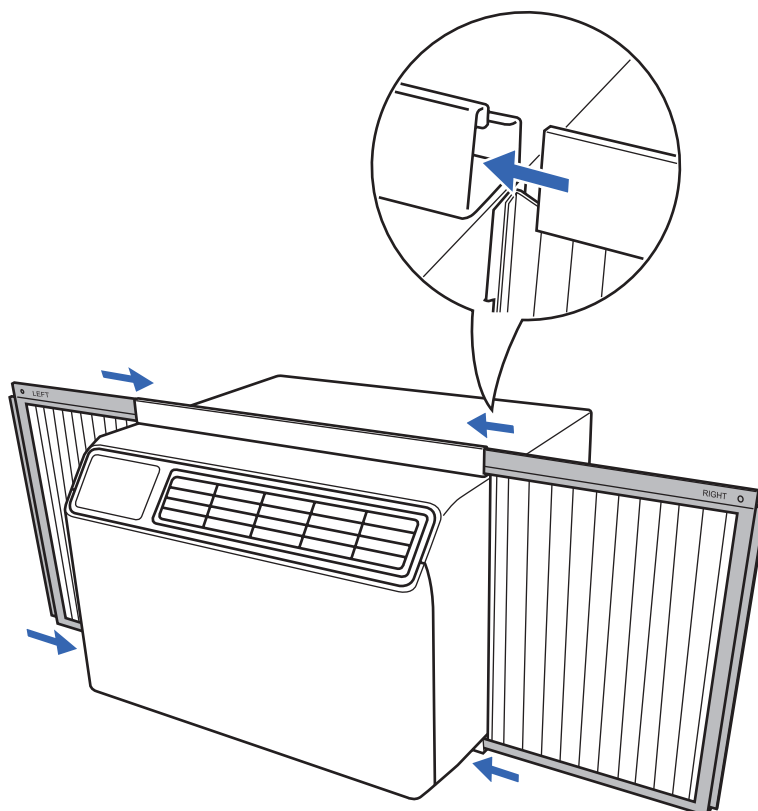



# Installation

## Install Window AC to the Window

1. Place the AC on the window with the bottom rail rest against the corner of the sill and the stool.
2. Center the AC and close the window sash onto the top mounting rail. The AC should be around 3° tilted towards the outside.

NOTE: Tilt the AC outside to prevent condensate or rain water from back flowing into the house.



- If installing the window AC on a window with storm window frame, a elevated board need to be installed on top of the window stool in order to keep the AC properly tilted towards outside.

### Normal Window

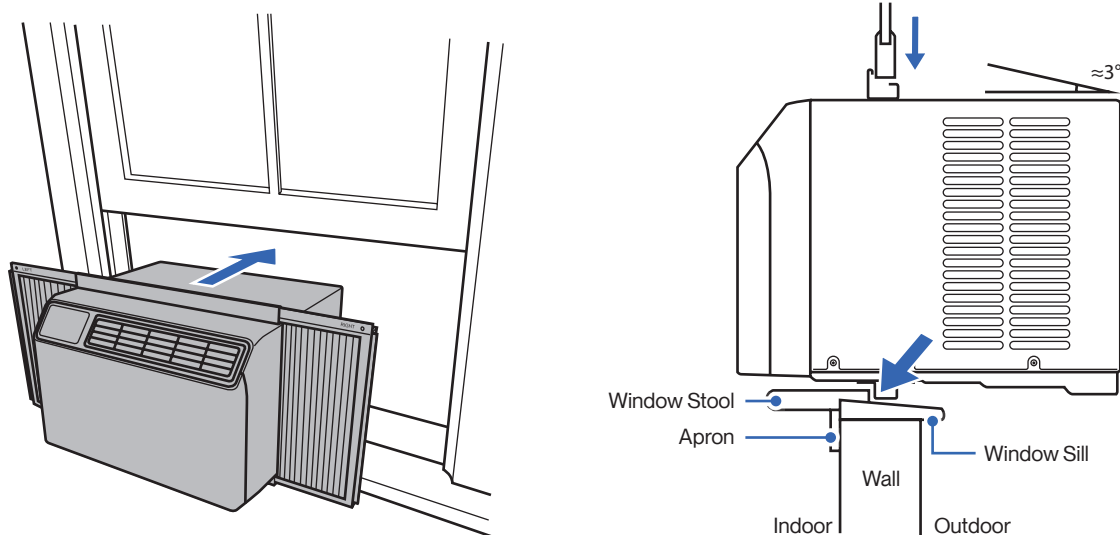

### Window with Storm Window Frame

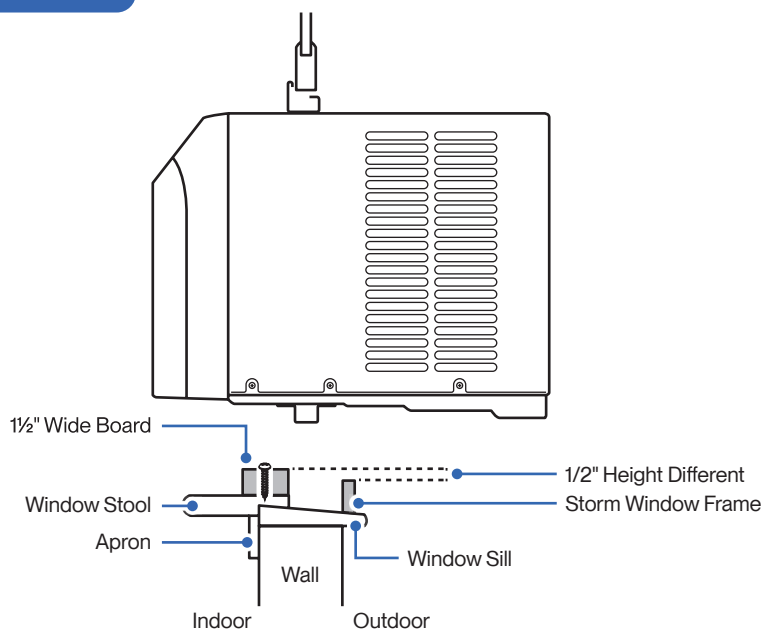

## Installation

### Secure Window AC In Place

1. Fully extend the filler panels to the sides of the window.
2. Fit frame locks between the filler panels and window stool, then lock them in place with 3/4" screws.
3. Secure the AC top rail and filler panels to the window sash with 1/2" screws.

Installation  
Installation

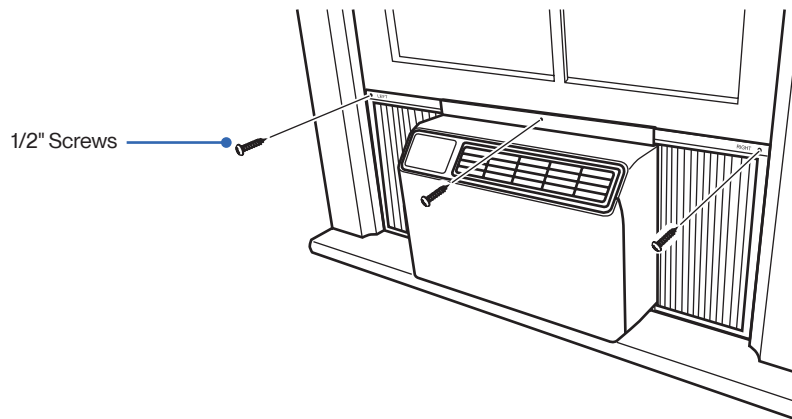
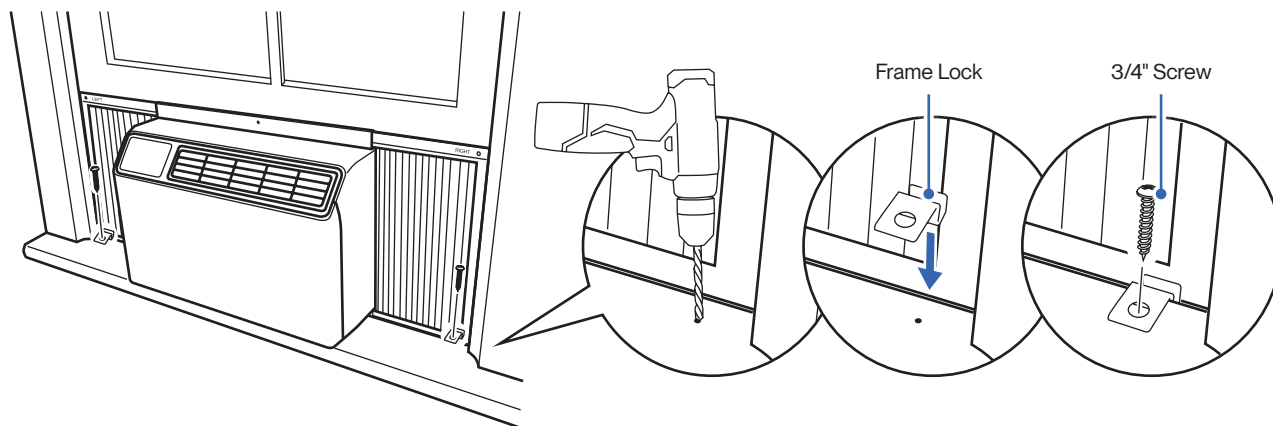
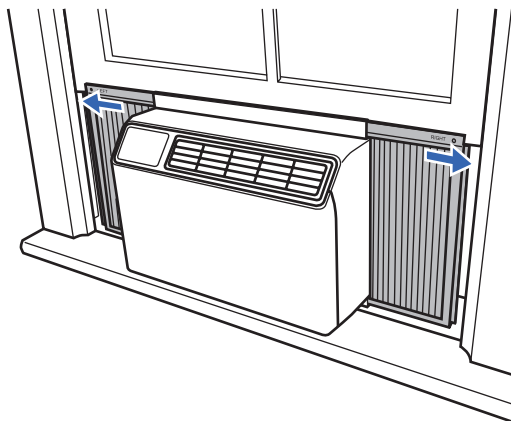

## Installation

### Hold Down the Window Sach and Insulation

1. Make sure the bottom window sach is push down all the way against the window AC, then secure it in place with sach lock and 3/4" screws.
2. Measure and cut window sach seal to the length of your window sach width. Insert the sach seal to the gap between the bottom window sach and top window sach as additional insulation.

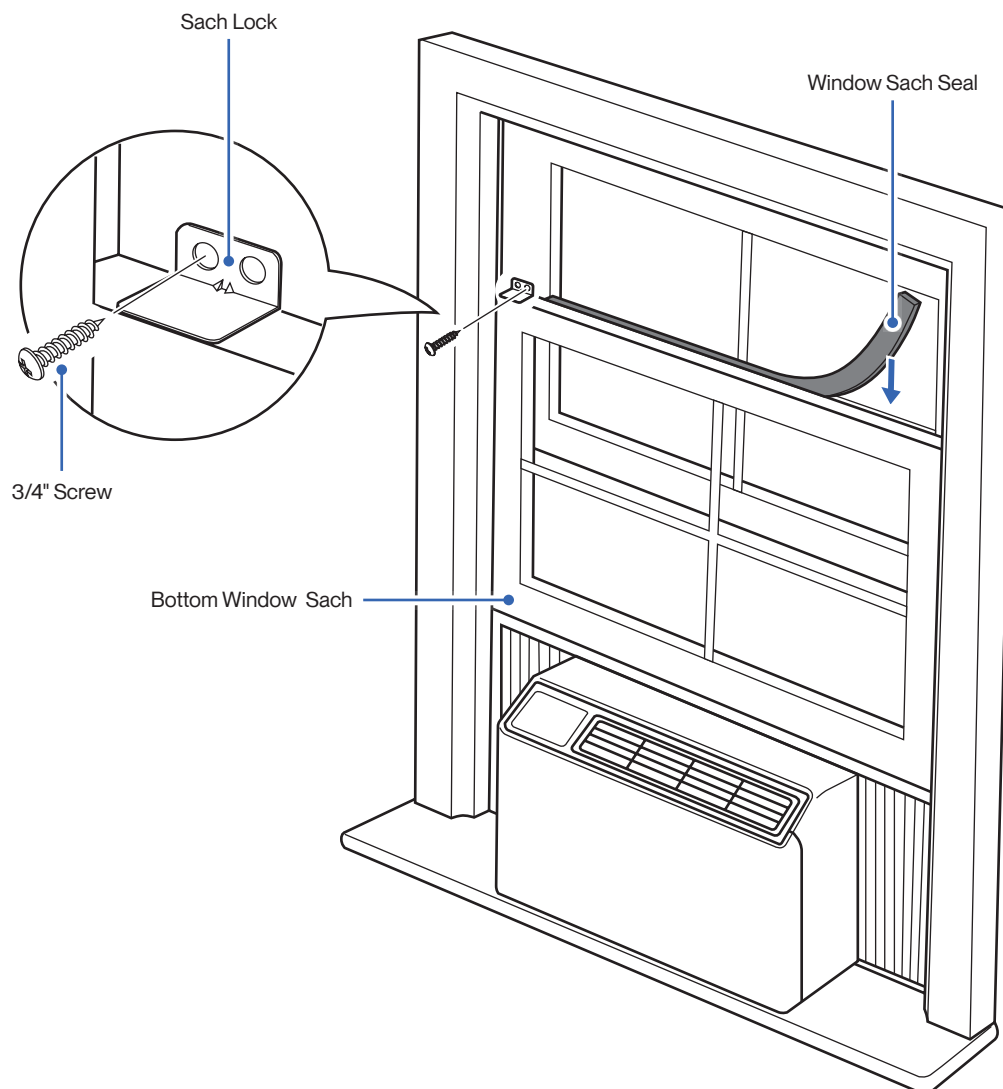

#### WARNING

- Lock down the bottom window sach to prevent the window sach from opening and dropping the window AC out of the window, which could potentially injuring people or animals on the other side.

## Installation

### Power Connection

1. Insert the power plug into a wall power socket.



**WARNING**

- The AC should only be plugged into a 3 prong wall outlet. If a 3 prong is not available, it is the customer's responsibility to have a grounded 3 prong outlet properly installed by a qualified electrician.
- Do not use a power strip or extension cord to minimize the possibility of electrical shocks, sparks, or fire.

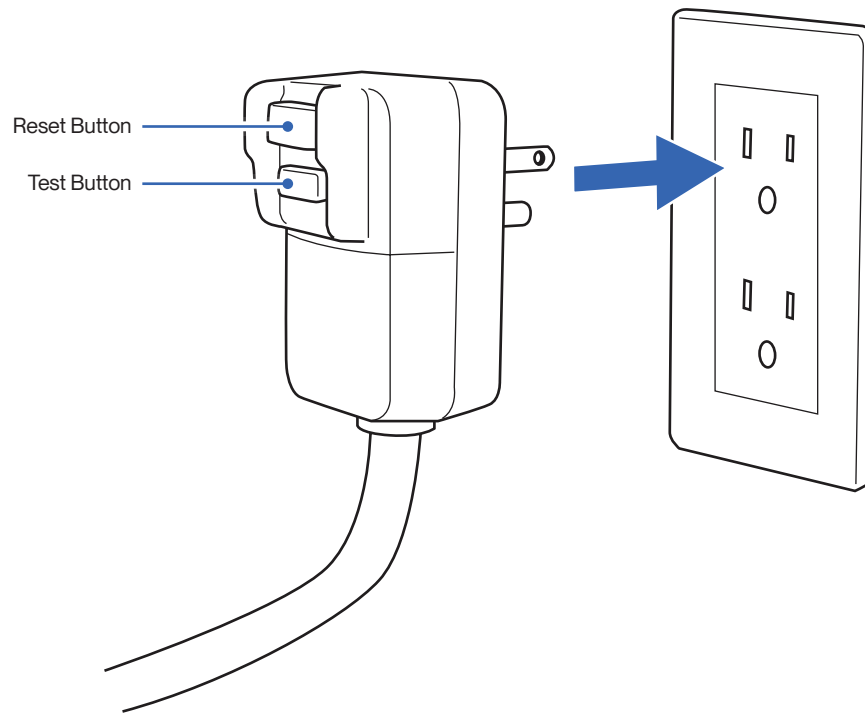

### Power Plug Testing

This appliance is equipped with a Leakage Current Detection Interrupter (LCDI) plug. LCDI plug will disconnect the unit from power if it senses leakage current.

Test the LCDI plug to check if the plug is functioning properly.

1. Insert the plug into a grounded 3 prong power outlet.
2. Press the RESET button.
3. Press the TEST button. If the plug is functioning properly, the circuit should tripped, cutting power and the appliance should not work.
4. Press the RESET button again, you will hear a click and the appliance should work again without any problem.



**WARNING**

- Do not operate the appliance with a defective LCDI plug.

## Before Using

### Operation Tips

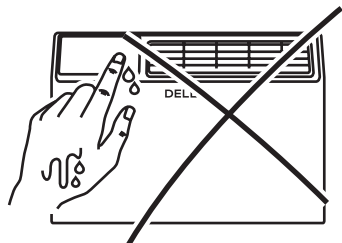

Avoid operating the air conditioner with wet hand.

- It may cause electric shock.

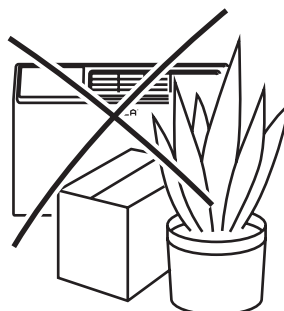

Avoid putting plants or objects around the air conditioner.

- It may block air flow and lower the air conditioner efficiency or cause malfunction.

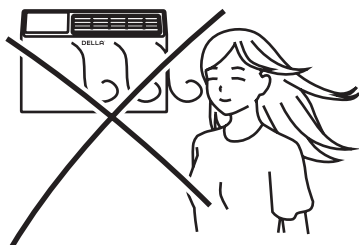

Avoid direct wind flow to people, pets, or plants.

- Expose to direct wind flow for extended period of time may have a negative impact on your health.

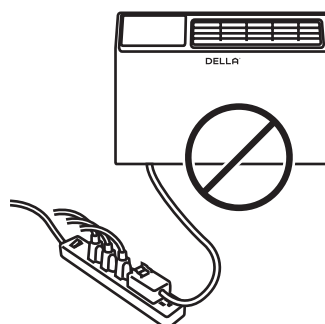

DO NOT plug the air conditioner to a power strip.

- It may leads to power strip overload and overheat, potentially cause electric shock and fire.

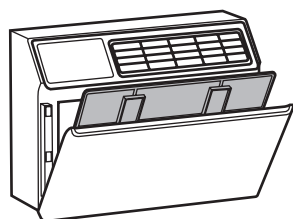

Follow cleaning and maintenance routine.

- Regular cleaning and maintenance are needed for the best efficiency and prevent bad odor or water leak.

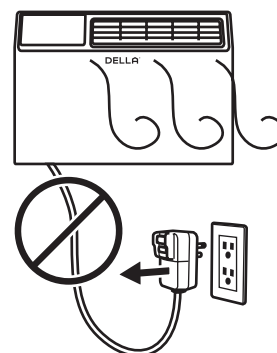

DO NOT disconnect the air conditioner from power socket before shutting down.

- It may cause electric spark and fire.

Before Using

Parts of the Air Conditioner

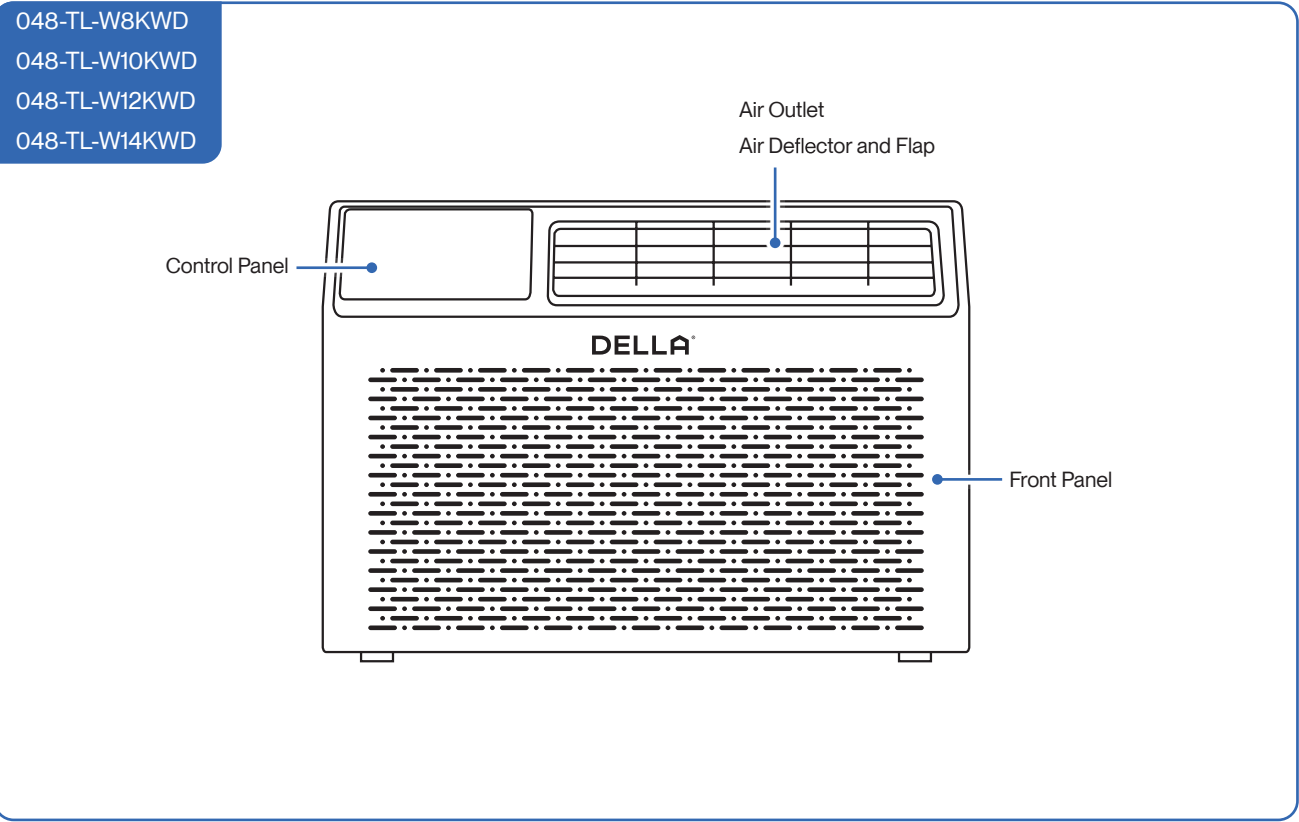

# Before Using

## Control Panel

- 048-TL-W8KWD
- 048-TL-W10KWD
- 048-TL-W12KWD
- 048-TL-W14KWD

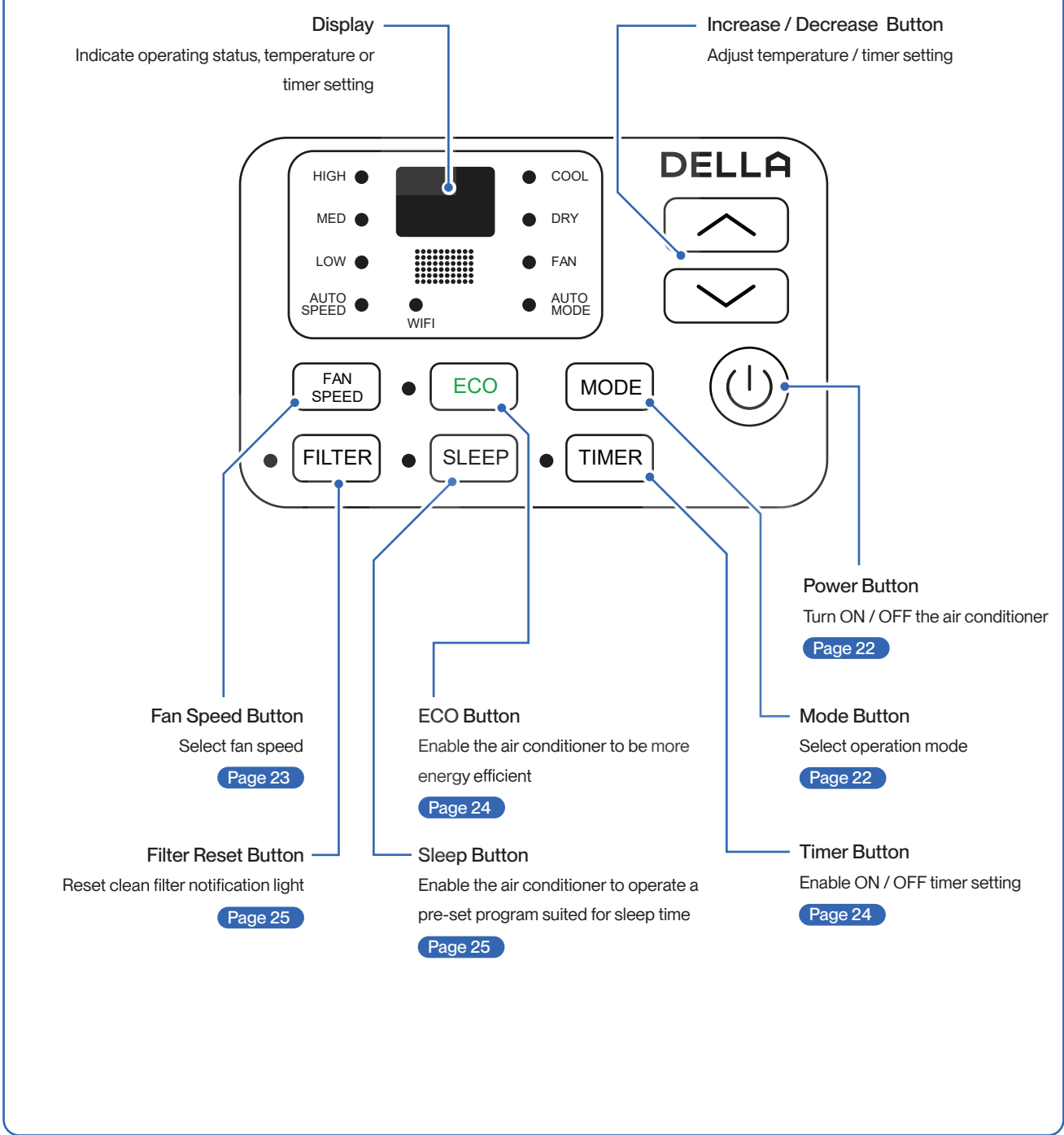

Before Using  
Before Using

## Before Using

### Remote Control (Insert Battery)

1. Slide and remove the battery tray from the remote control.
2. Place a CR2025 coin battery into the battery compartment in correct polarity.
3. Reinstall the battery tray into the remote control.

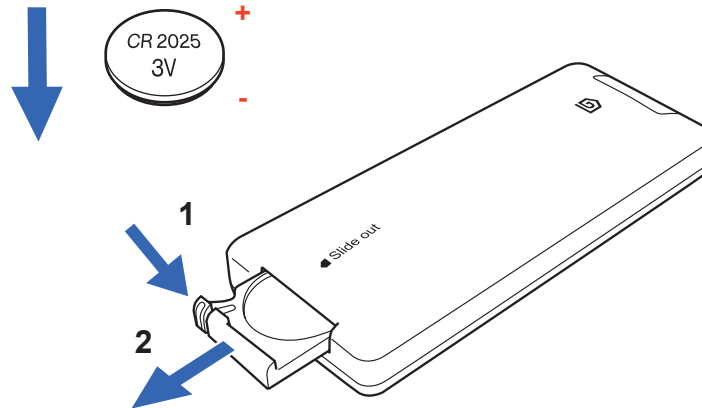

From the back of the remote control, push the left fastener of the battery tray to the right while holding the top of battery tray and pulling out.

Note: Before using, please take out the insulating strip from the bottom of remote control.

### Remote Control

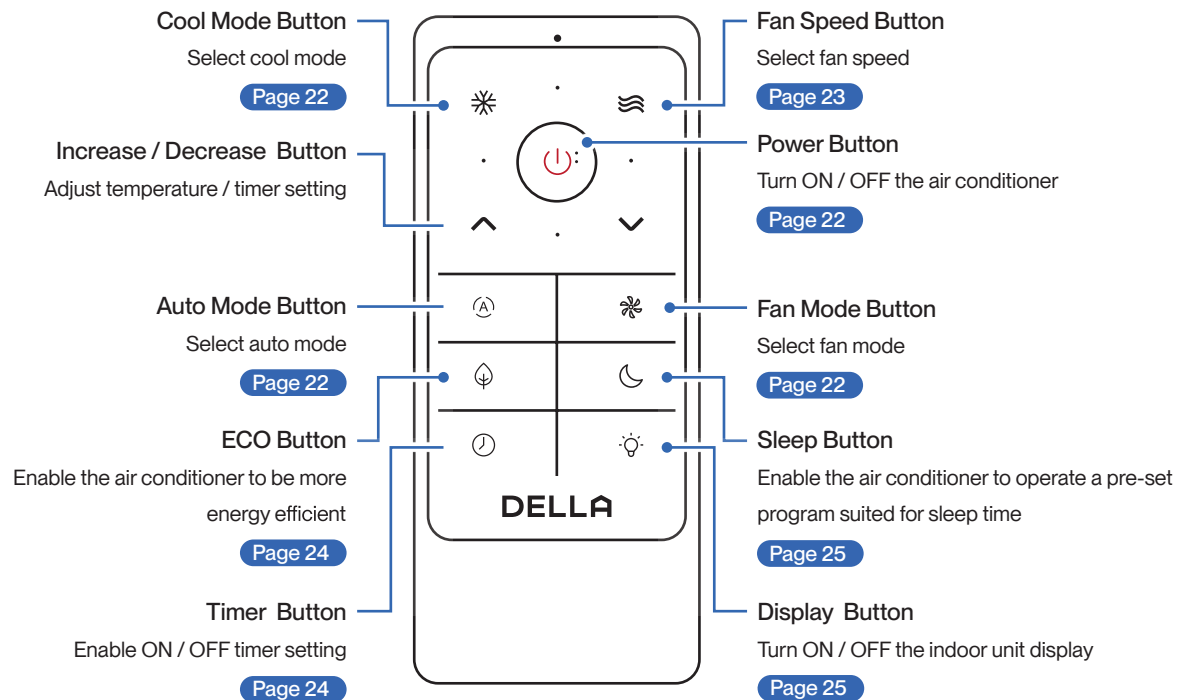



Coin Cell Battery Safety Warning:



<b>⚠ WARNING</b>	
<ul style="list-style-type: none"><li>• <b>INGESTION HAZARD:</b> This product contains a button cell or coin battery.</li><li>• <b>DEATH</b> or serious injury can occur if ingested.</li><li>• A swallowed button cell or coin battery can cause <b>Internal Chemical Burns</b> in as little as <b>2 hours</b>.</li><li>• <b>KEEP</b> new and used batteries <b>OUT OF REACH</b> of <b>CHILDREN</b></li><li>• <b>Seek immediate medical attention</b> if a battery is suspected to be swallowed or inserted inside any part of the body.</li></ul>	

- a ) Remove and immediately recycle or dispose of used batteries according to local regulations and keep away from children. Do NOT dispose of batteries in household trash or incinerate.
- b ) Even used batteries may cause severe injury or death.
- c ) Call a local poison control center for treatment information.
- d ) Compatible battery type: CR 2025, Voltage: 3V.
- e ) Non-rechargeable batteries are not to be recharged.
- f ) Do not force discharge, recharge, disassemble, heat above (manufacturer's specified temperature rating) or incinerate. Doing so may result in injury due to venting, leakage or explosion resulting in chemical burns.
- g ) Ensure the batteries are installed correctly according to polarity (+ and -).
- h ) Do not mix old and new batteries, different brands or types of batteries, such as alkaline, carbon-zinc, or rechargeable batteries.
- i ) Remove and immediately recycle or dispose of batteries from equipment not used for an extended period of time according to local regulations.
- j ) Always completely secure the battery compartment. If the battery compartment does not close securely, stop using the product, remove the batteries, and keep them away from children.
- k ) Do not ingest battery, Chemical Burn Hazard.
- l ) This product contains a coin or button cell battery. If the coin or button cell battery is swallowed, it can cause severe internal burns in just 2 hours and can lead to death.
- m ) Keep new and used batteries away from children. If the battery compartment does not close securely, stop using the product and keep it away from children. If you think batteries might have been swallowed or placed inside any part of the body, seek immediate medical attention.

Before Using  
Before Using



Basic Operation

Power ON

Press **POWER** or  on the control panel or press  on the remote control.

- The air conditioner will start operating.

Power OFF

Press **POWER** or  on the control panel or press  on the remote control.



- The air conditioner will stop operating.

Select Operation Mode

Press **MODE** on the control panel to select operation mode.



Alternatively, on the remote control,

- Press  to select cool mode;
- Press  to select fan mode;
- Press  to select auto mode.



NOTE: Dry mode is not selectable using the remote control and is only available on the control panel.

- Cool Mode: The air conditioner will cool the room according to your set temperature.
- Dry Mode: The air conditioner will automatically alternate between cooling cycles and fan function to reduce humidity in your room.
- Fan Mode: The air conditioner will circulate air in the room.
- Auto Mode: The air conditioner automatically select operation mode based on build in program logic.



Auto mode operation	
Room temp. $\geq$ 79°F / 26°C	Cool Mode, Set temp. 73°F / 23°C
Room temp. 68°F - 79°F / 20°C - 26°C	Dry Mode, Set temp. = Room temp. - 4°F / 2°C
Room temp. < 68°F / 20°C	Fan Mode

# Basic Operation



## Adjust Temperature

- Press   on the control panel or remote control to adjust temperature setting.
- Temperature setting will adjust by 1°F / 1°C increment for each time the button is pressed.
  - Temperature can only be set between 61°F - 88°F / 16°C - 31°C.

## Set Fan Speed

Press  on the control panel or press  on the remote control to select your desired fan speed.



	Cool Mode	Dry Mode	Fan Mode	Auto Mode
 Temperature Setting	61°F - 88°F / 16°C - 31°C		N/A	
 Fan Speed	All Fan Speed		High, Med, Low	All Fan Speed

## Advance Function

### Timer Function (Shutdown Timer)

Set a timer to automatically turn OFF the air conditioner.

Press **TIMER** on the control panel or  on the remote control when the air conditioner is ON.



Press   to set the desired turn off time.

Press **TIMER** on the control panel or  remote control again to confirm the timer setting.

### Timer Function (Start-up Timer)



Set a timer to automatically turn ON the air conditioner.

Press **TIMER** on the control panel or  on the remote control when the air conditioner is OFF.

Press **MODE** on the control panel or  /  /  on the remote control to select operation mode.

Press   to set the desired temperature.

Press **TIMER** on the control panel or  on the remote control again.

Press   to set the desired start-up time.

Press **TIMER** on the control panel or  on the remote control one more time to confirm the timer setting.





- Both the shutdown and start-up timer can be set between 0.5 - 24 hours.
- Timer can be set in 0.5 hour increment below 10 hours, and in 1 hour increment between 10 and 24 hours.
- To cancel timer setting, press **TIMER** on the control panel or  on the remote control after the timer has been set.

### ECO Mode

Press **ECO** on the control panel or  on the remote control to enable ECO mode.

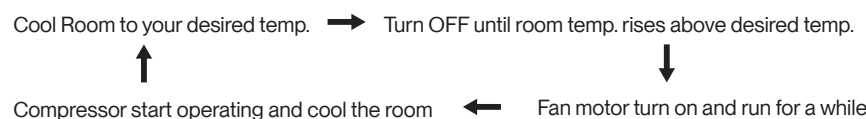
#### ECO mode operation



Press **ECO** on the control panel or  on the remote control again to disable ECO mode.

## Advance Function



### Sleep Mode

In sleep mode, the air conditioner will operate a pre-set program which is suitable during sleep.

Press  on the control panel or  on the remote control to enable sleep mode.

#### Sleep mode operation

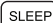
- When sleep mode is enabled, sleep mode light indicator will be turn on after 30s, and then all indicator lights will be off.
- During sleep mode, the air conditioner will raise the temperature by 2°F / 1°C every 30 - 60 minutes until the set temperature reach 82°F / 28°C.
- During sleep mode, the air conditioner will automatically adjust fan speed.

Press  on the control panel or  on the remote control again to disable sleep mode.

### Display ON / OFF

Switch ON / OFF the display on the control panel.

Press  on the remote control to turn OFF the indoor unit display.

Press  on the remote control again to turn ON the indoor unit display.

NOTE: Display control is only available using the remote control and is not on the control panel.

### Filter Reset Button

The filter check light wil turn on after the fan motor works for 500 total hours as a reminder to clean the filter.

Press  on the control panel to reset the filter check light indicator after cleaning the air filter.

NOTE: Filter check light can only be reset on the control panel and is not accessible on the remote control.

### Wi-Fi Reset

Press  on the remote control 6 times in 4 seconds on the remote control to reset and ready for pairing with your air conditioner to the "Della+" app.

## Advance Function

### Wi-Fi Set up

Beside the remote control, you can control your Della AC via the Della + app.

1. Search "DELLA+" on Apple app store or Google Play, or scan the QR code below to download the application.
2. Register an account in the app.
3. Follow the in app instructions to add and pair your Della AC to the app and complete the Wi-Fi set up.



#### Device QR code

Scan this QR code to add device to your Della+ app.



- The Della+ application is free, however, data charges may apply when downloading or using the application.
- Della + can be altered without notice for quality improvement and also be deleted depending on the circumstances of manufacturing firms.
- All trademarks, logo, brand names are the property of their respective companies. Use of these names, brands, and trademarks does not imply endorsement. Della assumes no responsibility with regard to the performance or use of these products.



Check out detailed tutorial on the most updated application on [dellahome.com/support](http://dellahome.com/support)

## Care and Maintenance



- Before cleaning the unit, you must shut down the machine and cut off the power supply for at least 5 minutes.
- Never flush the air conditioner with water.

### Clean the Unit

1. Clean the air conditioner with a soft dry cloth or a dampened cloth with neutral detergent.
2. Remove any possible debris on the vents and air outlet.

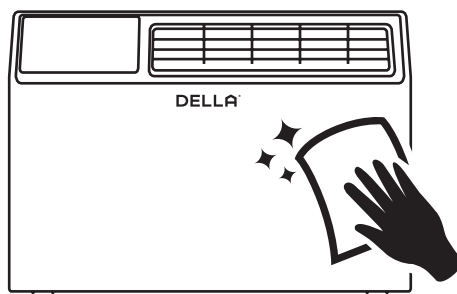

### Clean the Air Filter

1. Remove the air filter from the air conditioner.
2. Clean the air filter with soapy water.
3. Air dry the air filter.
4. Put the air filter back to its original position after it is dry.

048-TL-W8KWD  
048-TL-W10KWD  
048-TL-W12KWD  
048-TL-W14KWD

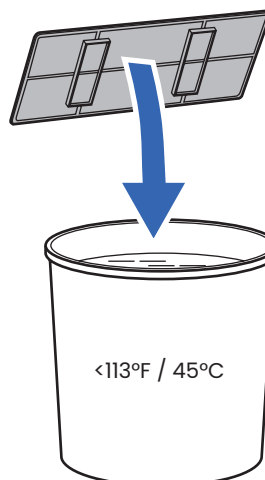
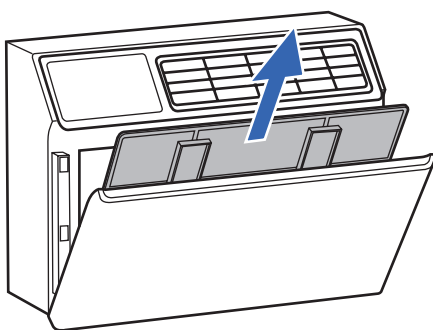

- Check and clean the air filter regularly to prevent dust accumulation.
- Clean the air filter frequently if the operating environment is dusty or has bad air quality.

## Care and Maintenance

### Maintenance Routine

- Clean the air filter screen every month.
- Regularly check and remove any obstacles from the air vent.

### Planning to Not Operate the Air Conditioner for a Long Period

- Take out the batteries from the remote control and disconnect the power supply of the air conditioner.

### Using the Air Conditioner After a Long Idle Period

- Clean the unit and the air filter screen.
- Remove any obstacles at the air inlet and outlet.
- Install batteries into the remote control and connect the power supply to the air conditioner.



# Troubleshooting

Before consulting repair or warranty, please check the following troubleshooting guide.  
In the case of an persistent problem, contact a qualified technician for diagnosis and repair.



- When encountering persisting problem, stop operation and turn off the breaker. Continue operation in an abnormal condition may cause electric shock, fire, or damage to the unit.
- Do not attempt to repair or modify the unit by yourself. Incorrect work may result in electric shock, fire or injury.

Problem	Possible Cause / Explanation / Solution
The air conditioner is non operational	The power cord is not plugged to a electric outlet.
	The house's circuit breaker box tripped. Check and reset the breaker.
	When pressing the power button soon after power failure - The internal protection is acticated, wait for a few minutes for the AC to resume normal operation.
	The LCDI plug tripped. Reset the power plug.
	Fauly electric connection, mismatch outlet voltage, or damaged electronic control board. Contact a qualified technician.
The air conditioner does not cool	Restricted airflow. Try clearing any obstacles blocking the air outlet.
	Check and make sure the temperature setting is below the room temperature.
	Air filter is too dirty. Clean the air filter.
	Cold air is leaking out from the room. Close windows to prevent cold air leaking out.
	Other heat source in the room. Remove heat source.
Strange odor from the air flow	Air filter is too dirty. Clean the air filter.
	The smells of the room, furniture, or cigarettes are absorbed into the unit and then discharged. Remove odorous objects from the room.

Having Problems?  
Having Problems?

Troubleshooting

Problem	Possible Cause / Explanation / Solution
Mist comes out from the air outlet	This occurs when the air in the room becomes cold in cool or dry mode. This does not indicate a problem.
Strange Noise	In the case of water flowing noise - The noise may caused by the refrigerant flow, or the internal water flow during cold / dry mode. This is not a malfunction.
	In the case of plastic cracking noise - The noise may caused by the thermal expansion on plastic parts and does not indicate a problem..
Water Dripping Outside	This is normal, especially during hot and humid days.
Water Dripping Inside	The air conditioner is not correctly tilted towards outside. Re-position your air conditioner and make sure the unit is slightly tilted downward towards the outside.
The air conditioner does not respond to the remote control commands	Remote Control is too far away from the air conditioner.
	There is an obstruction between the remote control and the air conditioner..
	The battery power has run out in the remote control. Replace the battery.
The display on the air conditioner is not lit	The display is set to off on the remote control. Use the remote control to turn it on.
	Power failure. Check the power supply / circuit breaker.



Switch off the air conditioner immediately and cut off the power supply in the event of:

- Strange, loud noises during operation.
- Faulty electronic control board.
- Faulty fuses or switches.
- Spraying water or objects inside the appliance.
- Frequent circuit breaker tripped during operation.
- Abnormally hot or damaged power cord or plug.
- Very strong smells discharging from the appliance.

Having Problems?  
Having Problems?

## Disposal Guideline

This appliance contains refrigerant and other potentially hazardous materials. When disposing of the appliance, follow all federal, state, and local regulations. DO NOT dispose of this product as normal household waste or unsorted municipal waste.

When disposing of this appliance, you have the following options:

- Dispose of the appliance at a designated municipal electronic waste collection facility.
- When buying a new appliance, the retailer will take the old appliance.
- The manufacturer may take back the old appliance.
- Sell the appliance to a certified scrap metal dealer.

Warranty



Scan the QR code or visit our page on [dellahome.com/pages/warranty](https://dellahome.com/pages/warranty) to sign up for warranty coverage on your new DELLA appliance.



[dellahome.com/pages/warranty](https://dellahome.com/pages/warranty)



## Compliance Information

### Radio Frequency Interference

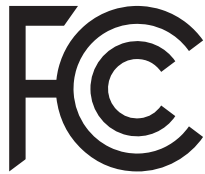

Model: 048-TL-W8KWD / 048-TL-W10KWD / 048-TL-W12KWD / 048-TL-W14KWD

ID: 2ANDL-WBR3

#### FCC Caution

This device complies with part 15 of the FCC Rules. Operation is subject to the following two conditions:

(1) This device may not cause harmful interference, and (2) this device must accept any interference received, including interference that may cause undesired operation. Any changes or modifications not expressly approved by the party responsible for compliance could void the user's authority to operate the equipment.

NOTE: This equipment has been tested and found to comply with the limits for a Class B digital device, pursuant to Part 15 of the FCC Rules.

These limits are designed to provide reasonable protection against harmful interference in a residential installation. This equipment generates, uses and can radiate radio frequency energy and if not installed and used in accordance with the instructions, may cause harmful interference to radio communications. However, there is no guarantee that interference will not occur in a particular installation. If this equipment does cause harmful interference to radio or television reception, which can be determined by turning the equipment off and on, the user is encouraged to try to correct the interference by one or more of the following measures:

- Reorient or relocate the receiving antenna.
- Increase the separation between the equipment and receiver.
- Connect the equipment into an outlet on a circuit different from that to which the receiver is connected.
- Consult the dealer or an experienced radio / TV technician for help.

## Introduction to Refrigerants R32

The refrigerants used for air conditioners are environmentally friendly hydrocarbons R32.

This kind of refrigerant is combustible and odorless. Moreover, it can burn and explode under certain conditions. However, there will be no risk of burning and explosion if you comply with the following table to install your air conditioner in a room with an appropriate area and use it correctly.

Compared with ordinary refrigerants, Refrigerant R32 is environmentally friendly and does not destroy the ozone sphere and that its value of greenhouse effect is also very low.



- Please read the manual before installation, using, maintenance.
- Do not use means to accelerate the defrosting process or to clean, other than those recommended by the manufacturer.
- Do not pierce or burn the appliance.
- The appliance shall be stored in a room without continuously operating sources (for example: open flames, an operating ignition gas appliance or an operating electric heater.)
- Please contact the nearest after-sale service center when maintenance is necessary. At the time of maintenance, the maintenance personnel must strictly comply with the Operation Manual provided by the corresponding manufacturer and any non professional is prohibited to maintain the air conditioner.
- The handling, installation, storage, servicing and disposal must comply with the provisions of gas-related national laws and regulations, and also national wiring regulation.
- It is necessary to clear away the refrigerant in the system when maintaining or scrapping an air conditioner. Be aware that refrigerants may not contain an odour.

This appliance is not intended for use by persons (including children) with reduced physical, sensory or mental capabilities, or supervision or instruction concerning use of the appliance by a person responsible for their safety. Children should be supervised to ensure that they do not play with the appliance. Unit operation limits: Outdoor side 61-110°F, 80%RH, indoor :side 61-90°F, 80%RH.



